

OVS

Residential Wall Fan Heater



OVRP

Residential Ceiling Fan Heater

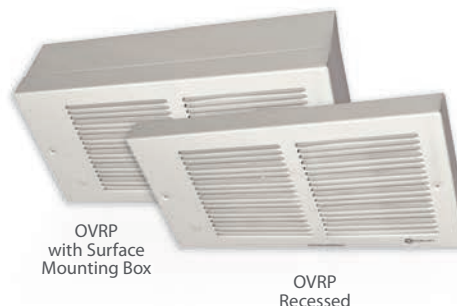

Features

Color

- Standard: white, almond.
- Optional (upcharge applicable): metallic silver, bronze, metallic charcoal, aluminum, semi-gloss black, sand.
- Custom colors available upon request.

Finish

- Standard: epoxy/polyester powder paint.

Construction

- 20-gauge steel cabinet.
- 22-gauge steel front cover.
- High-limit temperature control with automatic reset.

Fan

- Quiet fan operating.
- 120V, 208V, 240/208V models:
500W to 1000W; 40 cfm fan and 1250W to 2000W; 80 cfm fan.
- 347V models : 80 cfm fan.
- Factory-lubricated motor.

Heating element

- 120V, 208V, 208/240V: durable tubular heating element with fins.
- Factory sealed element available.
- 347V: Iron-Chromium-Aluminum alloy.

Control

- If an electronic thermostat is used, it must be compatible with forced-air heaters.

Installation

- Quick installation with recess box mounting holes.
- Large wiring compartment.
- Surface mounting box available.
- Tight fit with V-shaped recess box.

Warranty

- 5-year warranty against defects.

Application

- Entrance way, kitchen, bathroom, family room, basement.

OVS Features

Voltage

- 120V, 208V, 240/208V, 347V, 1-phase.

Control

- Built-in thermostat available with a control knob or tamperproof.

Installation

- Wall installation only.
- The air outlet should be installed at least 10 in. (25.4 cm) above floor.
- May be recessed in 2 in. X 3 in. stud partitions.

OVRP Features

Voltage

- 120V, 240/208V, 347V, 1-phase.

Control

- Must be used with a compatible wall thermostat (not included).

Installation

- Ceiling installation only.
- The air outlet should be installed at least 10 in. (25.4 cm) from the wall.
- May be recessed in ceiling.

Mounting positions available. Pictures showing front panel. Directional vane air flow.

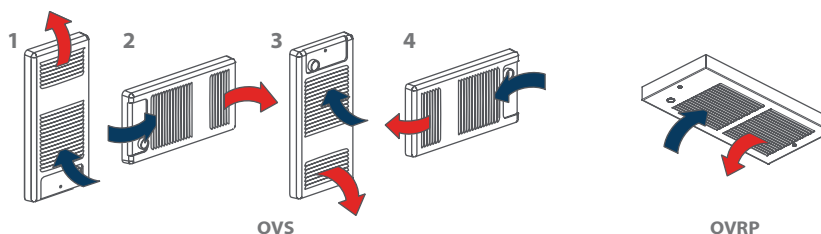

OVS Models

| Watts | Watts 240/208V | Product # | | | | Weight | |
|-------|-------------------|-----------|---------|----------|---------|--------|-----|
| | | 120V | 208V | 240/208V | 347V | lb | kg |
| 500 | 500/375 | OVS0502 | - | OVS0500 | - | 9.0 | 4.1 |
| 750 | 750/563 | OVS0752 | - | OVS0750 | - | 9.0 | 4.1 |
| 1000 | 1000/750 | OVS1002 | - | OVS1000 | OVS1007 | 9.0 | 4.1 |
| 1250 | 1250/938 | OVS1252 | - | OVS1250 | - | 9.0 | 4.1 |
| 1500 | 1500/1125 | OVS1502 | - | OVS1500 | OVS1507 | 9.0 | 4.1 |
| 2000 | 2000/1500 | - | OVS2008 | OVS2000 | OVS2007 | 9.0 | 4.1 |

OVS Options

| Product # Kit | Product # Factory installed* | Description |
|------------------------------|---------------------------------|---|
| KIT-OVS-BS | - | Surface mounting box |
| KIT-OVS-DIS ¹ | DIS ¹ | Disconnect switch, 20A at 277V max. (120V, 208V, 240/208V only) |
| - | ES ² | Factory sealed element (120V, 208V, 240/208V only) |
| KIT-OVS-TB6 | TB6 | Single-pole bi-metal thermostat (347V factory installed only) |
| KIT-OVS-TB26 ³ | TB26 ³ | Double-pole bi-metal thermostat (347V factory installed only) |
| KIT-OVS-TB6-AV | TB6AV | Single-pole bi-metal tamperproof thermostat (347V factory installed only) |
| KIT-OVS-TB26-AV ³ | TB26AV ³ | Double-pole bi-metal tamperproof thermostat (347V factory installed only) |

OVRP Models

| Watts | Watts 240/208V | Product # | | | | Weight | |
|-------|-------------------|-----------|----------|----------|--|--------|-----|
| | | 120V | 240/208V | 347V | | lb | kg |
| 500 | 500/375 | OVRP0502 | OVRP0500 | - | | 9.0 | 4.1 |
| 750 | 750/563 | OVRP0752 | OVRP0750 | - | | 9.0 | 4.1 |
| 1000 | 1000/750 | OVRP1002 | OVRP1000 | OVRP1007 | | 9.0 | 4.1 |
| 1250 | 1250/938 | OVRP1252 | OVRP1250 | - | | 9.0 | 4.1 |
| 1500 | 1500/1125 | OVRP1502 | OVRP1500 | OVRP1507 | | 9.0 | 4.1 |
| 2000 | 2000/1500 | - | - | OVRP2007 | | 9.0 | 4.1 |

OVRP Options

| Product # Kit | Product # Factory installed* | Description |
|--------------------------|---------------------------------|---|
| KIT-OVR-BS | - | Surface mounting box |
| KIT-OVR-DIS ¹ | DIS ¹ | Disconnect switch, 20A at 277V max. (120V, 208V, 240/208V only) |
| - | ES ² | Factory sealed element (120V, 208V, 240/208V only) |

* For factory installed options, add the option number to the product number. See the **Product Code** section inside the front cover.

¹ For the U.S. only: The nominal current of the unit must not exceed 80% of the capacity of the disconnect.

² The option "sealed element" increases the reliability of these in humid environments. It does not completely eliminate the leakage currents of metal sheathed heating elements.

³ "Off" position.

Add "BL" for white, "AM" for almond.

Upcharge applicable for optional colors shown in the color chart section.

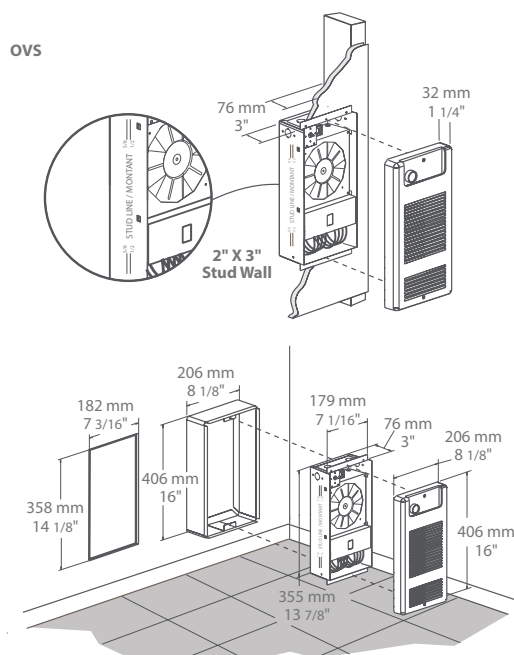

OVRP

